



VHL Central

Supersite® 3.0

Portales, Portails, PRIME

Instructor Guide

Vista Higher Learning Tech Support:

<https://support.vhlcentral.com/hc/en-us/requests/new>

Trademark and License Information

Copyright © and ® 2021 Vista Higher Learning

All rights reserved. No part of this publication may be reproduced without the prior written permission of the publisher. Published in the United States of America.

Assessment Builder: Create a Custom Assessment

Getting started: You can start from an existing assessment or from scratch.

1. Start from existing assessment:

a. Make a copy of the existing content, click the copy icon.

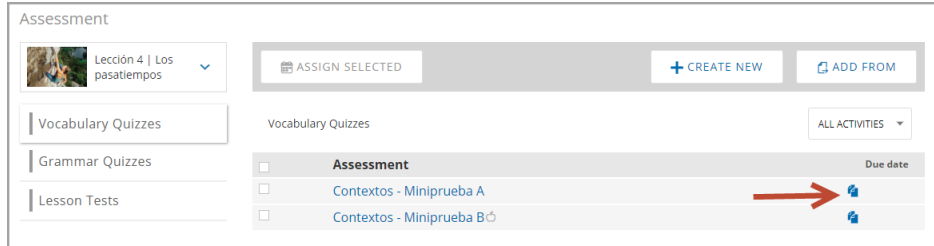

b. Click the Pencil icon to EDIT and/or ADD SECTIONS to the assessment.

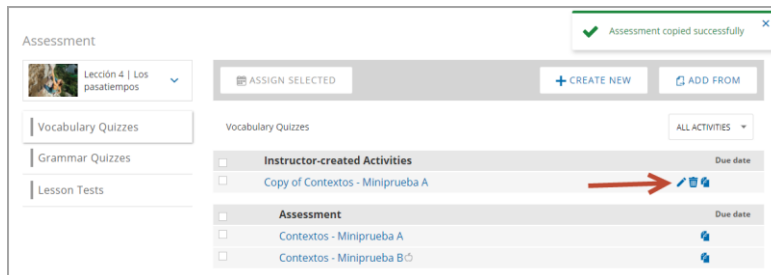

2. Start from scratch:

a. Go to CREATE NEW < Assessment



b. Click the pencil icon to edit:

- The Instructor title – only the instructor will see this.
- The assessment location in the table of contents and the gradebook.
- The title that Students see in their account.

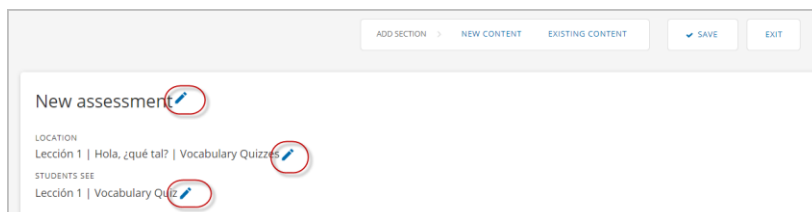

ADD CONTENT TO YOUR ASSESSMENT

1. Write your own CONTENT

- Go to NEW CONTENT
- Select the question type from the panel on the left

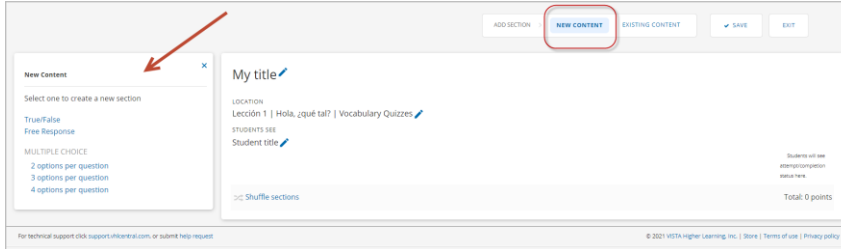

- Click the pencil icon to edit
- SAVE the section

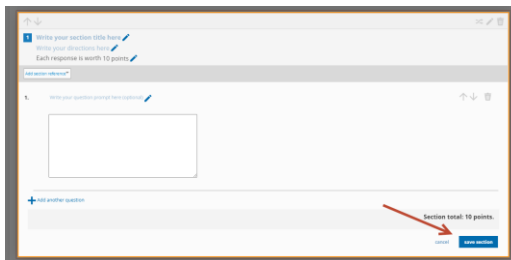

- You can continue adding sections of NEW Content by repeating the steps above.
- Each new section will be added to the bottom of the assessment

2. Add existing VHL content to your assessment:

- Click EXISTING CONTENT at the top of your screen.

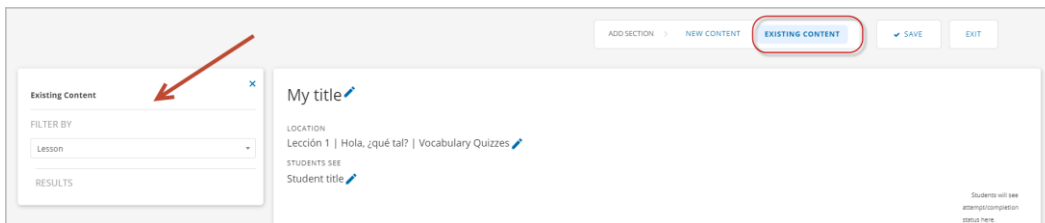

- Filter by Lesson and Strand (optional) and select the assessment

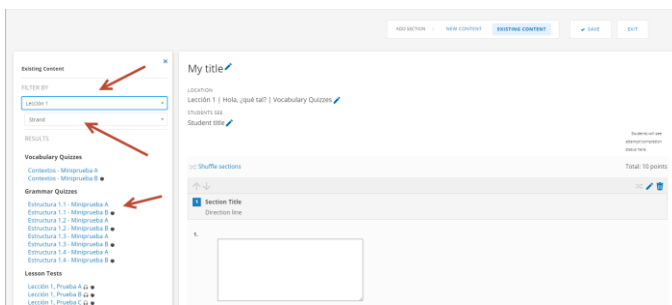

- b. You can SELECT ALL, UNSELECT ALL, or choose specific sections by checking the box next to the section.
- c. Click IMPORT to add the selected sections to your assessment.

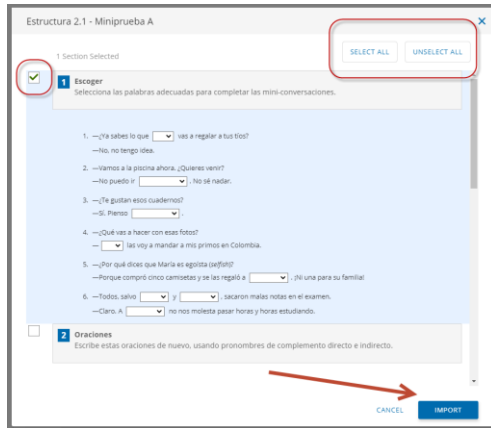

- You can continue to add existing content by repeating the steps above.
- Each new section will be added to the bottom of the assessment

EDIT the Assessment

- The pencil icon indicates an area that can be edited
- Edit the Section
 - Shuffle the questions within a section (*when applicable).
 - Edit questions within a section.
 - Delete the section.
- Click “shuffle sections” to change the order of the sections as they appear on the assessment
- Shuffle sections and move a section up or down in the assessment

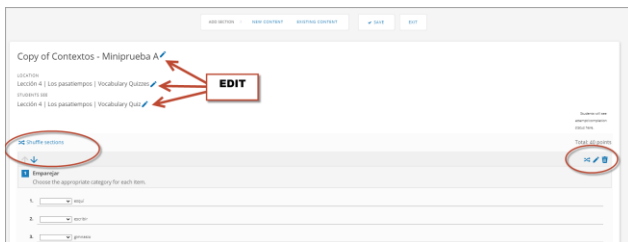

SAVE your Assessment

- SAVE will keep you in the Assessment Builder
- EXIT will take you back to the Assessment Dashboard

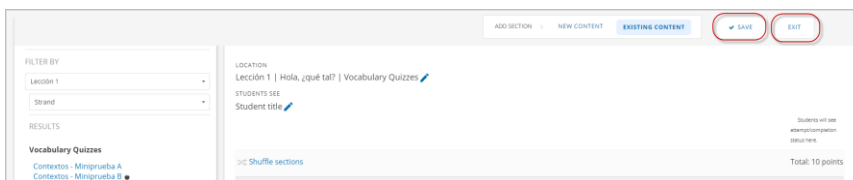

- If the assessment has not been saved, when clicking on Exit, you will see a pop-up message with more saving options

